

AUTOMOTIVE CAMPERS



**ALL ALUMINUM
CONSTRUCTION**



**Take Your Family
Camping with Your
Car or Minivan!**

CAMPLITE is truly the NEXT GENERATION of Light Weight Campers! Built of ALL Aluminum and Composites, these campers are 98% Recyclable! Unlike traditional RVs that are constructed of primarily wood and steel which will rot and rust, the CAMPLITE is built to stand the test of time! CAMPLITE is still priced very competitively, making it the best value on the road for young families wanting to utilize their smaller, more fuel-efficient vehicles.



**Available in
Exciting Metallic
Exterior Colors!**

**Interiors Feature
All Aluminum
Cabinetry, Ceiling,
Walls and Floor!**



16BHB

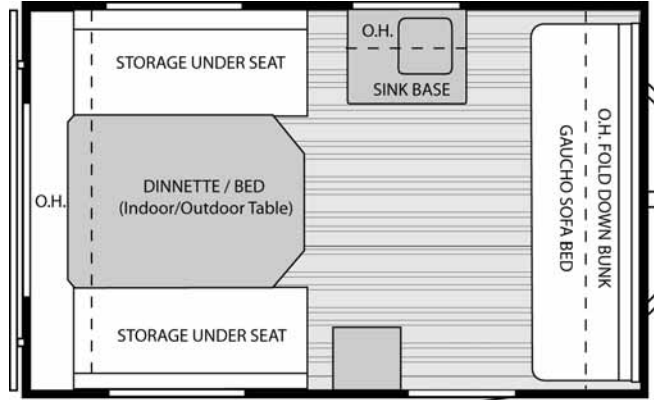

Box Length: 11'-0" GVWR: 2500 lb.
Dry Weight: 1,200 lb.

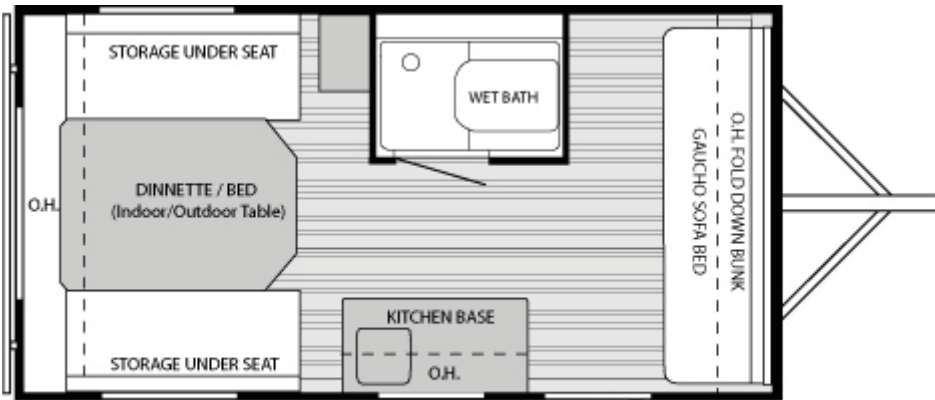

Box Length: 13'-0" GVWR: 2500 lb.
Dry Weight: 1,800 lb.

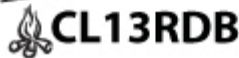

**Now Available with
Tip-Out Bunks!**



**Take Your Family
Camping with Your
Car or Minivan!**



Box Length: 13'-0" GVWR: 2500 lb.
Dry Weight: 1,600 lb.

**Available with a Rear
Wet Bath Option.**

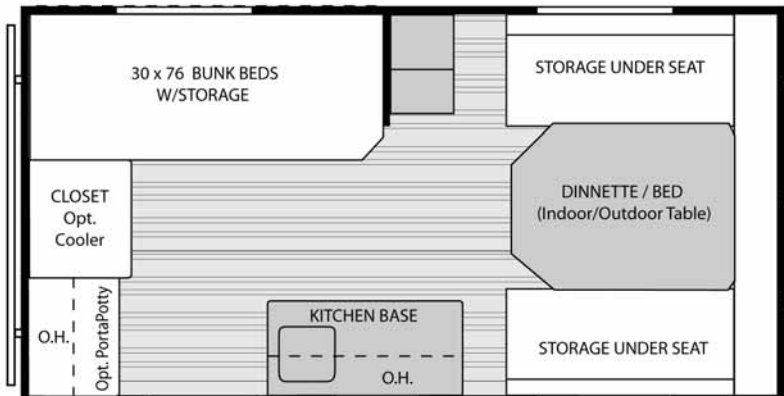
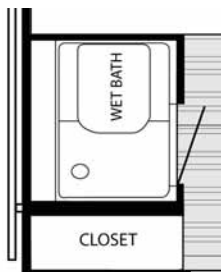

**ALL Aluminum
and Composite
Construction!**

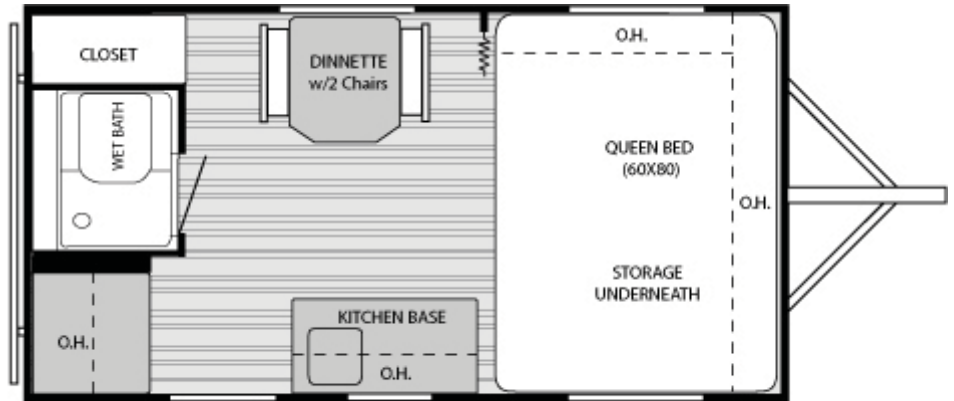

Box Length: 11'-0" GVWR: 2500 lb.
Dry Weight: 1,800 lb.

CL13QBB

**The Most Durably
Constructed
Lightweight on the
Market!**

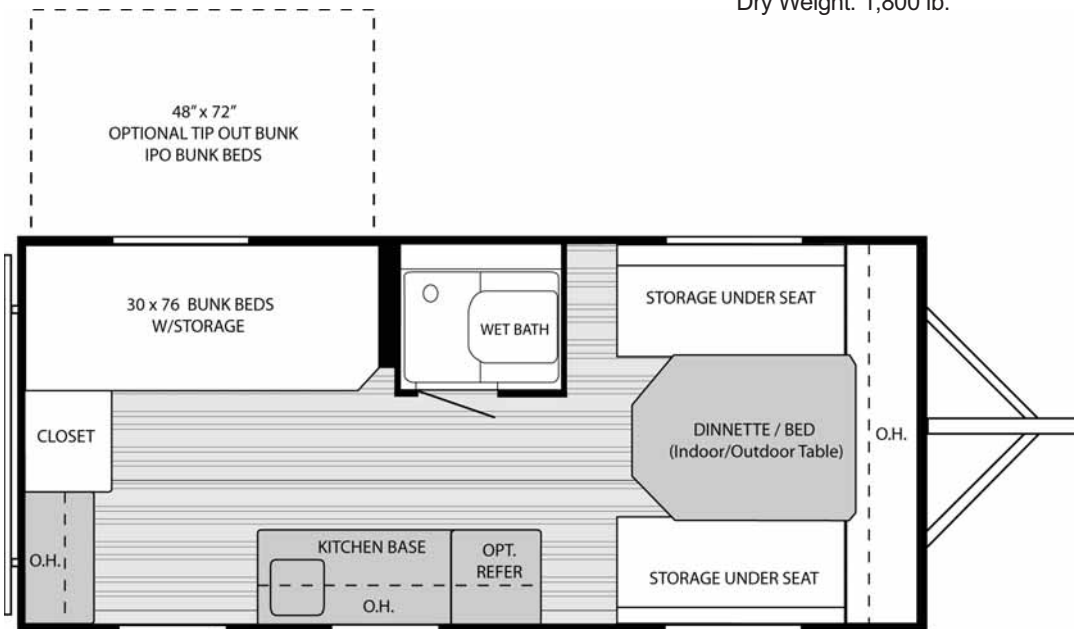

Box Length: 16'-0" GVWR: 4400 lb.
Dry Weight: 2,300 lb.

CL16BHB

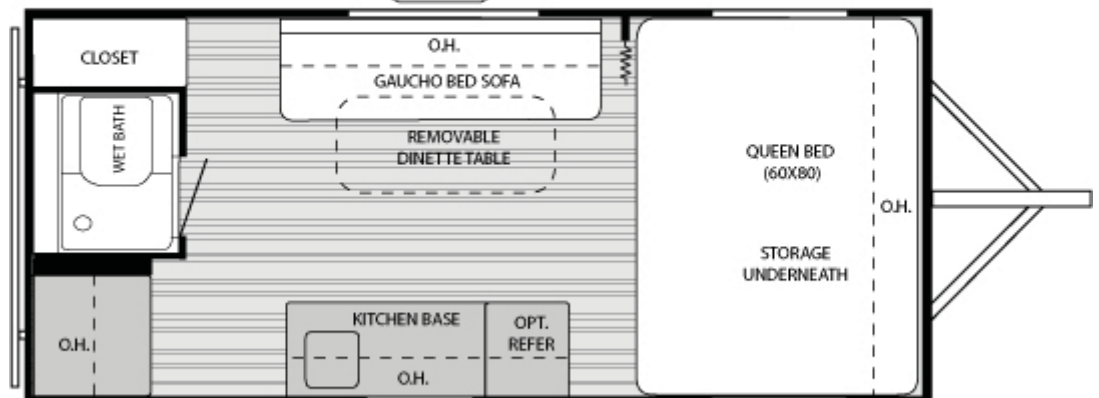

Box Length: 16'-0" GVWR: 4400 lb.
Dry Weight: 2,300 lb.

CL16QBB

Weights based on standard equipment. Options will add weight. Some weights estimated and based on similar models. Specifications subject to change without notice or obligation to LIVIN LITE RV.



STANDARD FEATURES

- 1. Tubular Aluminum Frame**
Lightweight; Durable; will not rust away like typical steel frames.
- 2. Dexter™ Independent Torsion Suspension**
Provides the smoothest ride, best tracking and less rebound in all terrains - compared to outdated spring leaf suspensions.
- 3. Inter-Locking Alumina-Plank® Floor Deck**
Lightweight; Durable; will not rot away, sag or have soft spots like typical plywood floor decking. Frankly, there's just no comparison to conventional trailers here.
- 4. Tubular Aluminum Sidewall Framing**
Lightweight; Durable; will not rot away like wood.
- 5. Aluminum Sidewall Skin Inside & Out**
Lightweight; Strong; Durable; offers the option of colors vs. competition's white.
- 6. Diamond Plate Aluminum Rockguard and Trim Package (automotive styling)**
Protective; Durable and Adds a Great Look to the Exterior of the Camper.
- 7. Fully Insulated Sidewalls and Roof**
Lightweight, Block Foam Insulation, laminated for maximum strength.
- 8. Tubular Aluminum Bunk Bed Framing**
Lightweight; Durable; will not rot away, vs. wood bases.
- 9. Tubular Aluminum Cabinet Framing**
Lightweight; Durable; water resistant; will not rot away like typical wood studs.
- 10. Aluminum Skinned Cabinetry**
Lightweight; Durable; Clean Look; Designed to stand the test of time - compared with the typical wood paneling.
- 11. Finished Aluminum Cabinet Doors**
Lightweight; Durable; Clean Look; Designed to stand the test of time - compared to typical "presswood" doors.
- 12. Lightweight European Composite Windows - Featuring Built-In Day/Night Shades and the Ability to be Propped Open.**

- 13. Lightweight Custom Crafted Countertops**
Lightweight; Durable; Water Resistant; Designed to stand the test of time - compared with the "presswood" tops.
- 14. 76" Interior Headroom**
No more bending over in your automotive camper! Enjoy the ability to walk around with plenty of head room - afforded by CAMPLITE'S increased interior spaciousness!
- 15. Automotive Exterior Colors**
Choose from a Variety of Metallic Exterior Metal Colors to Match Your Tow Vehicle!

OTHER GREAT FEATURES:

- All Aluminum Dinette Bases with Built-In Storage and Custom Cushions.
- Comfortable Mattresses on the Bunk Beds
Lightweight; Durable; Designed to be easily removed for washing.
- 12V&110V Electrical Outlets
Providing Convenient access to electric for fans, heaters, coolers, lights, etc.
- Wet Bath (where available)
Thetford Re-Circulating Commode with Shower (hot water heater/water pump)
- Exterior Shower (where available)
With Flexible Hose & Sprayer (H&C)
- Aluminum Mag Wheels
- Four Stabilizer Jacks
- Safety Chains
- Lighted, Molded License Plate Cover
- Spare Tire, Mounted Under the Camper
- Exterior Entrance Step

All illustrations and specifications contained in this literature are based on the latest product information at time of publication.
LIVIN LITE Recreational Vehicles, Inc., reserves the right to make changes in prices, colors, materials, equipment and specifications at anytime without notice or obligation.
All units are shipped F.O.B. Wakarusa, Indiana.
CONSULT YOUR LOCAL DEALER FOR WARRANTY INFORMATION.
5M 2/10

POPULAR OPTIONS

- **13.5 BTU A/C Unit (with Heat)**
- **Awning (or Awning Room)**
- **Porta Potty (where applicable)**
- **Electric Ice Box/Cooler**
- **LP Package:**
Furnace; Water Heater; Range
(Ask Dealer for Details)
- **Convenience Package:**
Portable Gas Range, Space Heater, First Aid Kit, Aluminum Indoor/Outdoor Table

NOTE: WET BATHS are available in certain models. These units include an electric hot water heater; water pump; hot and cold faucet at the sink; hot and cold exterior shower; and a re-circulating electric commode by Thetford™.

See our website or your nearest CAMPLITE dealer for more information and new product updates. www.LIVINLITE.com

SPECIFICATIONS & CAPACITIES:

Overall Lengths:
11RD - 14'-6"
13RDB; 13BH; 13QBB - 16'-6"
16BH; 16QBB - 19'-6"

Overall Width: 84"

Overall Height (with A/C): 114"

Tire Size: 13"

Wet Bath Models:
Fresh Water - 25 gal.
Grey Water - 18 gal.
ElectraMagic - 6 gal.
Additional Black - 5 gal.

NOTE: The Thetford ElectraMagic is a re-circulating toilet that uses very little water; offers convenient push button flushing and is self-contained. We have mounted this on a secondary black tank to double its capacity.



1025 E. WATERFORD • WAKARUSA, IN 46573 • PH. 574.862.2228
WWW.LIVINLITE.COM

Your Dealer